

Oklahoma Cemetery Directory

OKLAHOMA COUNTY



OHCE Genealogy Group
Oklahoma County, Oklahoma

Oklahoma Cemetery Directory

**Based on the original compilations of the
77 County Cemetery Indexes, by Oklahoma Home
and Community Education**

**©2016 OHCE Genealogy Group
Oklahoma County, Oklahoma**

Printed in the United States of America

CONTENTS

Remembering Our Dead

Saint Mary's Cemetery.....	2
Sunny Lane Cemetery	3
Sources of Cemeteries of Oklahoma	4
Township, Range, Section.....	4
McIntosh County OHCE Cemetery Map	5
McIntosh County Cemetery Legal Descriptions	6

REMEMBERING

We wish to remember all of those who have been laid to rest in the cemeteries of Oklahoma. There are more than 4,000 cemeteries in Oklahoma. Most of them are well cared for, and we are thankful for all of the time that is spent in taking care of them. The other cemeteries have been overtaken by grass, weeds, and brush, and may be forgotten. Those who are buried there may also be forgotten.

Take time to go to the cemeteries of your relatives and friends. Part of life is remembering and honoring the dead.



CREATING

Members of the Oklahoma Home and Community Education (OHCE) in the 77 counties of Oklahoma have put their cameras to work taking pictures of the cemeteries in their counties. They have written down the directions to the cemeteries and have added the legal descriptions. They have researched books and searched out neighbors who could tell the history of those cemeteries. Many others who have contributed to the Directory are listed on the Acknowledgments page. The collective efforts of all became the First Edition in May 2006. Additions made since then became the Second Edition beginning November 2007, during Oklahoma's Centennial year. Additions continue to be made as more cemeteries are located and more pictures are taken. This project is now under the administration of the Oklahoma County OHCE Genealogy Group.

The purposes of the Directory are to describe the cemeteries of Oklahoma and to help in the search for those who have been laid to rest. If cemeteries can be located, there should be more success in the search.

Oklahoma Cemetery Directory
Published by Oklahoma County OHCE Genealogy Group

Information may be copied from this book for personal use, but may not be copied for profit.

For a Centennial gift Oklahoma Home and Community Education, Inc. provided the Oklahoma History Center Research Library Cemetery Directories for all 77 Counties in Oklahoma listing all known cemeteries in each county which includes, when possible, driving directions, pictures and a brief history of each cemetery.

CEMETERY PICTORIAL VIEWS



New Cemetery 2006

Riverside Gardens Cemetery, Oklahoma City, OK

OKLAHOMA COUNTY OKLAHOMA

The pictorial views are arranged alphabetically.

SAINT MARY'S UKRAINIAN CEMETERY

aka Ukrainian

0.2 m. N of NE 63rd St. on N Dobbs Rd. [N of Harrah]
SW ¼, Sec.2, T12N, R1E, I.M.

Driving directions: Located on N Dobbs Rd 0.2 mile north of the intersection of NE 63rd St and N Dobbs Rd in Harrah, OK. From Oklahoma City, take I-40 east to Peebly Rd (exit 169). Go north (left) about 7.6 miles to NE 23rd St. Turn right (east) and go 1 mile to N Luther Rd. Turn left (north) and go 3 miles to NE 63rd St. Turn right (east) and go 1 mile to N Dobbs Rd. Turn left (north) and go 0.2 mile. The cemetery is on the right (east) side of the road.

History of St. Mary's Ukrainian Cemetery

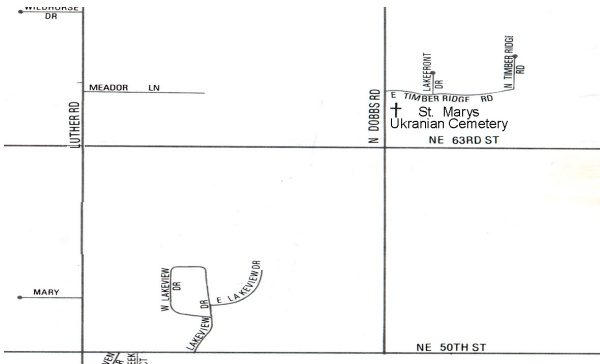

On 26 Dec 1918, Nickola “Mike” Tytenicz and Mike Patrick Sr., met with ten other interested people and organized the group to form the Ukrainian Orthodox Church near Harrah. A board was elected and on 24 May 1919, the membership bought an 80-acre farm three miles north and one mile west of Harrah (63rd and Dobbs Rd) from John and Helen Jodlowski.

The members built a church there which

was blessed (dedicated) 29 Sept 1919. This was the first Ukrainian Orthodox Church in Oklahoma. The original church burned in 1924 and was rebuilt in 1925. This second church burned in 1949 and at that time the members decided not to rebuild on this site. They sold 78 of the original 80 acres, keeping two acres to serve as a permanent cemetery.

The first recorded burial was 29 Mar 1919, so the land was being used for a cemetery even before the church was built. The cemetery is well kept and is in use today.



SUNNY LANE CEMETERY

SW Corner SE 29th St. & Sunnylan Rd. [Del City]
E ½, Sec. 18, T11N, R2W, I.M.

Driving directions: Located at the SW corner of the intersection of SE 29th St and S. Sunnylan Rd in Del City, OK. From Oklahoma City, take I-40 east to Sunnylan Rd (Exit 155A). This exits on to a frontage road, continue to Sunnylan Rd. Turn right (south) on Sunnylan and go 1.4 miles to SE 29th St. The cemetery will be on the far right side of the intersection. Turn right (west) and go ¼ mile. The entrance to the cemetery is on the left (south) side of 29th Street.

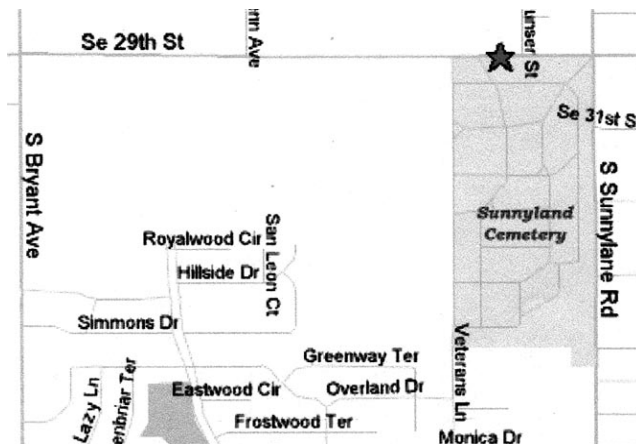

History of Sunny Lane Cemetery

This very well kept cemetery is one of the larger cemeteries in Oklahoma County. The original cemetery was located on church land in the south east corner of the present Sunny Lane Cemetery. The church later burned. This is now a privately owned cemetery of approximately 85 acres. Most of it is laid out in blocks with two rows of burial sites. Only one upright headstone is allowed on each pair of rows, and it must face out. Frequently a family group will have plots on both sides of an upright stone.



The cemetery now has computerized records. Researchers may call 405-677-8384 to check for specific burials there,

SOURCES FOR CEMETERIES OF OKLAHOMA

1 USGS - United States Geological Society and GNIS – Geographic Names Information System - cemetery names and coordinates of latitude and longitude.

2 Mapquest – mapquest.com – locations derived from USGS and GNIS coordinates.

3 ODOT - Oklahoma Department of Transportation – maps of each county. I highlighted cemetery locations, township lines, and township numbers.

4 OHCE - Oklahoma Home and Community Education Inc. The coordinators for each county provided pictures, legal descriptions, driving directions, cemetery descriptions, and history.

5 The Internet – filled in some gaps.

6 USGenWeb Archives – Oklahoma.

TOWNSHIP, RANGE & SECTION

Each piece of land in Oklahoma can be located by giving its township, range, and section. There are two areas for numbering – 74 counties and the Panhandle with 3 counties.

In the 74 counties townships are numbered from 1 South to 10 South and from 1 North to 24 North. Ranges are from 1 East to 27 East and from 1 West to 26 West.

In the Panhandle the townships are from 1 North to 6 North. The Ranges are from 1 East to 28 East.

6	5	4	3	2	1
7	8	9	10	11	12
18	17	16	15	14	13
19	20	21	22	23	24
30	29	28	27	26	25
31	32	33	34	35	36

Each township / range has 36 sections which are 36 square miles. They are numbered as the graph shows. As an example, the Oklahoma State Capitol in Oklahoma City is in Township 12 North, Range 3 West, and Sections 14 and 23.

Oklahoma Cemetery Directory

Legal Descriptions for Oklahoma County

Cem	Cemetery	Twp-Rng-Sec	Latitude	Longitude	Comments
altern	Albright Family Cemetery	T13N-R1W-Sec34SW	353308N	0971757W	aka Jones IOOF Cemetery
	All Souls' Episcopal Church Columbarium				
altern	Arbuckle Cemetery	T14N-R1W-Sec3SE/SW	354240N	0971731W	aka Spigener Cemetery
1	Arcadia IOOF Cemetery	T14N-R1W-Sec20SW	354025N	0972009W	Arcadia
2	Arlington Memory Gardens	T12N-R2W-Sec22NE	353020N	0972329W	Midwest City
altern	Atteberry Cemetery	T14N-R1W-Sec12NW	354237N	0971525W	aka Sweat Cemetery
altern	Benge Cemetery	T13N-R4W-Sec7SW	353655N	0974020W	aka Spring Creek Memorial Cemetery
altern	Bethany Catholic Cemetery	T12N-R4W-Sec17SE	353041N	0973843W	aka Saint Joseph's Cemetery
3	Bethany Cemetery	T12N-R4W-Sec4SW	353217N	0973809W	Bethany
altern	Bohemian National Cemetery	T11N-R3W-Sec19NE	352513N	0973323W	aka Czechoslovakian National Cemetery
4	Bradley Family Cemetery	T13N-R1E-Sec24NW	353527N	0970901W	east of Jones
5	Britton Cemetery	T13N-R3W-Sec29SE	353420N	0973157W	Oklahoma City
6	Carmelite Monastery of St. Joseph Cemetery	T14N-R4W-Sec19NW	354033N	0974017W	west of Edmond
7	Chapel Hill Memorial Gardens	T13N-R4W-Sec30NW	353428N	0974011W	Oklahoma City; north of Bethany
8	Chitwood Cemetery	T13N-R1W-Sec18NW	353630N	0972112W	northwest of Jones
9	Choctaw Elmwood Cemetery	T12N-R1W-Sec25NW	352912N	0971550W	aka Walker Cemetery; aka Elmwood Cemetery
10	Christner Cemetery	T14N-R4W-Sec3NW	354331N	0973644W	northwest of Edmond
altern	ClearSprings Cemetery	T11N-R2W-Sec24SE	352423N	0972141W	aka Clearsprings Mishak Cemetery
11	Clearsprings Mishak Cemetery	T11N-R2W-Sec24SE	352423N	0972141W	aka Mishak Cemetery; Mashak Cemetery
12	Collins Cemetery	T14N-R1W-Sec26NE	353936N	0971554W	Edmond
altern	Conception Catholic Cemetery	T11N-R4W-Sec23NW	352513N	0973602W	aka Immaculate Conception Cemetery
altern	Coon Creek Cemetery	T14N-R1W-Sec12NW	354237N	0971525W	aka Sweat Cemetery
altern	County Line Cemetery	T14N-R2W-Sec5NE	354329N	0972530W	aka Pleasant Hill Cemetery
13	Czechoslovakian National Cemetery	T11N-R3W-Sec19NE	352513N	0973323W	aka Bohemian National Cemetery
14	Dalrymple Family Cemetery	T13N-R1E-Sec28NW	353447N	0971232W	east of Jones
15	Donnell Cemetery	T14N-R1W-Sec5SW	354243N	0971911W	aka Soldier Creek Cemetery
altern	East Side Cemetery	T11N-R1E-Sec5SE	352700N	0971254W	aka Kansas School Cemetery
16	East View Cemetery	T12N-R2W-Sec8NE	353205N	0972555W	Oklahoma City
altern	Eighty-Niner Cemetery	T13N-R4W-Sec7SW	353655N	0974020W	aka Spring Creek Memorial Cemetery